

DO

DO SEAL ALL CUTS

DO APPLY HIGH QUALITY DECK OIL

DO USE PROPER SPACING BETWEEN
BOARDS BASED ON DIMENSION

DO ALLOW MIN 16" ABOVE GRADE
FOR PROPER VENTILATION

DO PRE-DRILL ALL SCREW HOLES

DO KEEP PILOT HOLES 3/4" AWAY
FROM ENDS OF BOARDS

DO USE HIGH QUALITY DECK SCREWS
WITH SQUARE OR STAR DRIVE HEADS

DO FOLLOW NUSKU THERMACOR
INSTALLATION INSTRUCTIONS

DO FOLLOW YOUR LOCAL BUILDING
CODE REQUIREMENTS

DO FOLLOW HIGHEST BUILDING
INDUSTRY STANDARDS

DO USE ONLY TOP QUALITY FINISHES &
FOLLOW MANUFACTURER'S INSTRUCTIONS

DO USE FINISHES THAT
CONTAIN A WATER REPELLENT

DO NOT

DO NOT USE INCORRECT SPACING
BASED ON DIMENSION

DO NOT USE LOW QUALITY SCREWS
WITHOUT PROPER HOLDING POWER

DO NOT INSTALL OR STORE IN
CONTACT WITH THE GROUND

DO NOT INSTALL WITH GAPS
BETWEEN END BOARDS

DO NOT STORE IN DIRECT
CONTACT WITH CONCRETE

DO NOT INSTALL WHERE WATER
SPRINKLERS OR FOUNTAINS
CAN REGULARLY WET

DO NOT INSTALL WITHOUT MIN
16" ABOVE GRADE

DO NOT FINISH OVER WET NUSKU
THERMACOR PRODUCT

DO NOT STORE WITH TIGHTLY
WRAPPED PLASTIC

DO NOT IGNORE QUICK
START GUIDE



"we harden homes"

READ ME
WUI INSTALLATION

FINISH THE PROJECT RIGHT



PROPER STORAGE



CORRECT HARDWARE

FAILURE TO FOLLOW PROPER INSTALLATION & FINISH PRACTICES WILL NEGATE PRODUCT WARRANTIES.

WOOD IS A PRODUCT OF NATURE. SO INDIVIDUAL PIECES VARY IN PERFORMANCE. DECKING, SIDING & EAVES ARE SINGULAR COMPONENTS OF A BUILDING. THE PERFORMANCE IS DEPENDENT ON MANY CRITICAL FACTORS INCLUDING THE STRUCTURE'S DESIGN, THE CRAFTSMEN'S SKILLS, THE USE OF OTHER MATERIAL, THE PRODUCTS EXPOSURE AND THE CLIMATE. THE MANUFACTURER AND MERCHANT HAVE NO CONTROL OVER THESE VARIABLES. FOLLOWING THIS MANUAL WILL HELP IN ACHIEVING SATISFACTORY PERFORMANCE UNDER MOST CONDITIONS; HOWEVER, IT WILL NOT GUARANTEE FLAWLESS PERFORMANCE. PLEASE REFER TO MANUFACTURER'S WARRANTY FOR ADDITIONAL INFORMATION.



SEAL ALL CUTS



TIME TO FINISH



STORAGE

STORE NUSKU THERMACOR IN A GARAGE OR SHED WITH ADEQUATE AIR CIRCULATION AND PROTECTION FROM THE ELEMENTS.

KEEP NUSKU THERMACOR DRY. IF IT CAN'T BE STORED UNDER A ROOF, PROTECT IT WITH A WATERPROOF COVER. MAKE SURE THE COVER IS SECURE BUT LOOSE ENOUGH TO PERMIT AIR CIRCULATION.

STORE NUSKU THERMACOR OFF THE GROUND, AWAY FROM WET CONCRETE AND PROTECTED FROM DIRT, MOISTURE, DIRECT SUN & EXTREME HEAT.

DEFINITELY
AVOID



EXCESSIVE
MOISTURE



EXCESSIVE
SUN



EXCESSIVE
HEAT



PROPER
CIRCULATION



GROUND
CLEARANCE



PROPER
COVERAGE

DEFINITELY
ALLOW

IF NUSKU THERMACOR IS EXPOSED TO EXCESSIVE HEAT OR SUN IT MAY SHRINK CAUSING CUPPING, CHECKING OR SAP BLEED. IF NUSKU THERMACOR IS EXPOSED TO EXCESSIVE MOISTURE IT CAN SWELL, RAISE GRAIN OR CAUSE CHECKING.



WUI SIDING

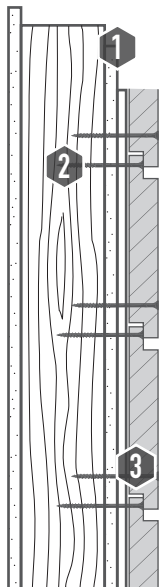

1 SHEATHING & VAPOR BARRIER

INSTALL MINIMUM NOMINAL 2x4 STUDS, 16" ON CENTER FOLLOWED BY MINIMUM 5/8" THICKNESS NATIONAL GYPSUM GOLD BOND eXP WITH 1/8" GAP (OR DENSGLASS). APPLY A VAPOR BARRIER (TYVEK) TO THE WALL, THEN ATTACH NOMINAL 1x2 VERTICAL FURRING STRIPS OVER THE VAPOR BARRIER 16" ON CENTER.

2 PRE-DRILL & SCREW

FOR HORIZONTAL WUI INSTALLATION, START AT THE BOTTOM OF THE WALL & PRE-DRILL HOLES ABOVE EACH FURRING STRIP WITH 1/8" DRILL BIT. DRIVE A 3" STAINLESS STEEL SCREW THROUGH THE 1/8" PRE-DRILLED HOLE TO SECURE THE BOTTOM HALF OF EACH BOARD. THEN PRE-DRILL THROUGH THE LAP & DRIVE A 3" STAINLESS STEEL SCREW TO SECURE THE TOP HALF OF EACH BOARD.

3 SPACING & PROFILE

UTILIZE A MAXIMUM OF 1" SHIPLAP REVEAL WHILE ALLOWING 1/16" AVERAGE SPACING FOR EXPANSION WITH SCREWS OR CLIPS.

EXAMPLES OF DECKING & HORIZONTAL INSTALLATION

PRO TIP:
KEEP PILOT HOLES
3/4" FROM EACH
END TO PREVENT
SPLITTING

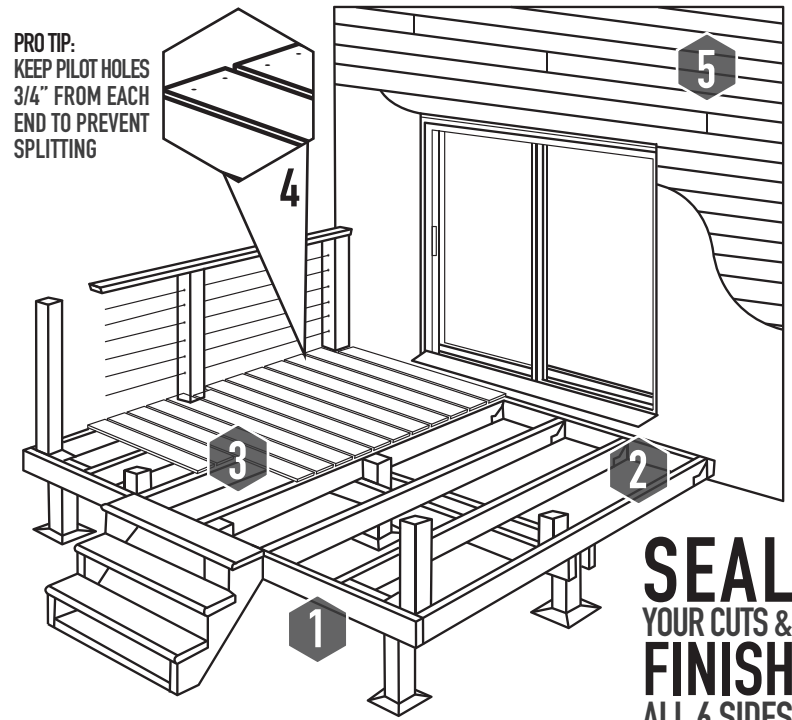

SEAL
YOUR CUTS &
FINISH
ALL 6 SIDES

1 VENTILATION

ALLOW FOR MIN 16" CLEARANCE BETWEEN UNDERSIDE OF DECKING & GROUND. ADEQUATE AIR CIRCULATION BENEATH THE DECK WILL HELP PREVENT CUPPING & WARPING. ADDITIONAL CLEARANCE IS RECOMMENDED IN WET AREAS.

2 SPAN

FOR WUI DECKING INSTALL NUSKU THERMACOR, MATERIAL NOMINAL 5/4x6 INSTALLED ON MINIMUM NOMINAL 2x6 DOUGLAS FIR JOISTS, 16" ON CENTER.

3 SPACING

WITH MATERIAL NOMINAL 5/4x6, INSTALL WITH MAXIMUM SPACING OF 3/16" EDGE TO EDGE FOR COMPLIANCE TO WUI TESTING

4 FASTENERS

TO PREVENT DISCOLORATION NEAR THE FASTENERS, STAINLESS STEEL SCREWS ARE RECOMMENDED AT A RATE OF TWO SCREWS PER JOIST. PRE-DRILLING IS REQUIRED AT ENDS OF BOARDS AND RECOMMENDED WHEN SCREWING THROUGH THE FACE. CONSULT DEALER FOR INFORMATION ON HIDDEN FASTENING SYSTEMS.

5 HIDDEN FASTENERS

FOLLOW INSTRUCTIONS FROM HIDDEN FASTENER MANUFACTURER WHILE UTILIZING ALL DETAILS ABOVE FOR BEST PRACTICES.

WUI DECKING